

Research Guide

Psychology

Subject librarian:

Judith Kupke

judith.kupke@ub.hu-berlin.de

Tel.: 030 / 2093-99704

<http://www.ub.hu-berlin.de/psychology>



How to find a specific title

The table below shows how to get access to particular books and journals of which you already have bits of bibliographic information, e.g. the name of the author, the title, or the ISBN. See the next page for more detailed information about these resources.

I am searching for...	HU	Berlin	Germany
Books	Primus Gateway	KOBV Gateway (incl. interlibrary loan)	Karlsruhe Virtual Catalogue (KVK)
Print Journals	Primus Gateway German Journal Database (ZDB)	German Journal Database (ZDB)	German Journal Database (ZDB)
E-Journals	Primus Gateway E-Journals Library (EZB)	E-Journals Library (EZB)	E-Journals Library (EZB)

How to find sources on a specific topic

The table below gives a selection of research tools to find books, journal articles and in-depth information related to your topic. See the next page for more details about these resources.

I would like to find...	
Books	Primus Gateway
General subject information (esp. journal article references)	Scopus*
Key psychology resources	PsycARTICLES* PsycBOOKS* PsycINFO* PSYINDEX* Psychology and Behavioral Sciences Collection* Lexikon der Psychologie* (<i>German only</i>)

*The marked resources are licensed by the Humboldt-Universität zu Berlin. Access is granted via IP range recognition, thus from PCs on the premises of HU, or via VPN (for authorized users only). Use is free of charge.

List of resources in alphabetical order

E-Journals Library (EZB)

Index of electronic journals with traffic light symbols:

red: no access (abstracts often available free of charge)

yellow: free access on campus of HU or via VPN

green: free access

- <http://www.ub.hu-berlin.de/en> → Literature Search → Journals → Electronic Journals

PsycARTICLES

PsycArticles is a full-text psychology database that contains articles from highly-cited and landmark journals published by the APA, its imprint the Educational Publishing Foundation (EPF), and from allied publishers/organizations. The database gives access to almost 200,000 articles from more than 100 peer-reviewed journals. Coverage spans from 1894 to present and includes all subject areas relevant to psychological science including basic research.

- via Primus Gateway, EZB or DBIS*

German Journal Database (ZDB)

Bibliographic database of printed and electronic serial titles. Holdings information for German and Austrian libraries. No full texts.

- <http://www.zdb-katalog.de>

or

- <http://www.ub.hu-berlin.de/en> → Literature Search → Journals → Printed Journals

PsycBOOKS

PsycBOOKS contains over 60,000 chapters (pdf) from over 4,000 publications, mostly of the American Psychological Association (APA), both current literature (with time delay) as well as classics. Exclusive electronic release of more than 1,500 authored entries from the APA/Oxford University Press Encyclopedia of Psychology.

- via Primus Gateway or DBIS*

Karlsruhe Virtual Catalogue (KVK)

Meta search engine for more than 500 million books and serials in library and book trade catalogues worldwide. Simultaneously searches in various catalogues. Gives you a standardized hit list.

- <https://kvk.bibliothek.kit.edu>

Psychology and Behavioral Sciences Collection

Database providing nearly 560 full text publications from topics such as emotional and behavioral characteristics, psychiatry & psychology, observational and experimental methods. Indexing and abstracts available for all journals in the collection. Coverage: 1965 - present.

- via Primus Gateway or DBIS*

KOBV Gateway

Central library portal for accessing information from libraries in Berlin and Brandenburg by one single request: online catalogues, databases, e-journals, links collections, subject portals, search engines.

- portal.kobv.de

PsycINFO

Abstracts of peer-reviewed journal articles (from 2,500 periodicals in various languages, dating from the 1800s to present), book chapters, books, and dissertations related to behavioral science and mental health. Over 4 million records and summaries from the 17th century to the present.

- via Primus Gateway or DBIS*

Lexikon der Psychologie (German only)

- Access from PC desktops in the ESZ: → CD-ROM-Service der UB → Lexikon der Psychologie

or

- via Primus Gateway or DBIS*

PSYINDEX

Abstract database of papers and books, audiovisual media (*PSYINDEX Literatur & AV-Medien*) and tests (*PSYINDEX Tests*) from various fields of psychology. Exclusively from the German speaking countries, but 30% of the records are in English or have English abstracts. Coverage: 1977 to the present. Scope: 270,000 literature and audiovisual media records, 6,000 test records.

- via Primus Gateway or DBIS*

Primus Gateway

Search engine for printed and electronic books, articles and journals. Besides our HU holdings Primus contains millions of external academic resources.

- <http://primus.ub.hu-berlin.de/en>

Scopus

Abstract and indexing database with access to peer-reviewed titles in health, sciences, engineering, social sciences, psychology, and economics; updated daily. Scopus currently provides access to over 70 million abstracts with coverage dating back to 1788. A citation tracker feature is included.

- <http://www.scopus.com>

or

- via Primus Gateway or DBIS*

*These resources are accessible from our Datenbank-Infosystem (DBIS):

<http://www.ub.hu-berlin.de/en> → Literature Search → Databases → DBIS → Psychologie

Plan of Erwin-Schrödinger-Zentrum



Ground floor

Gallery

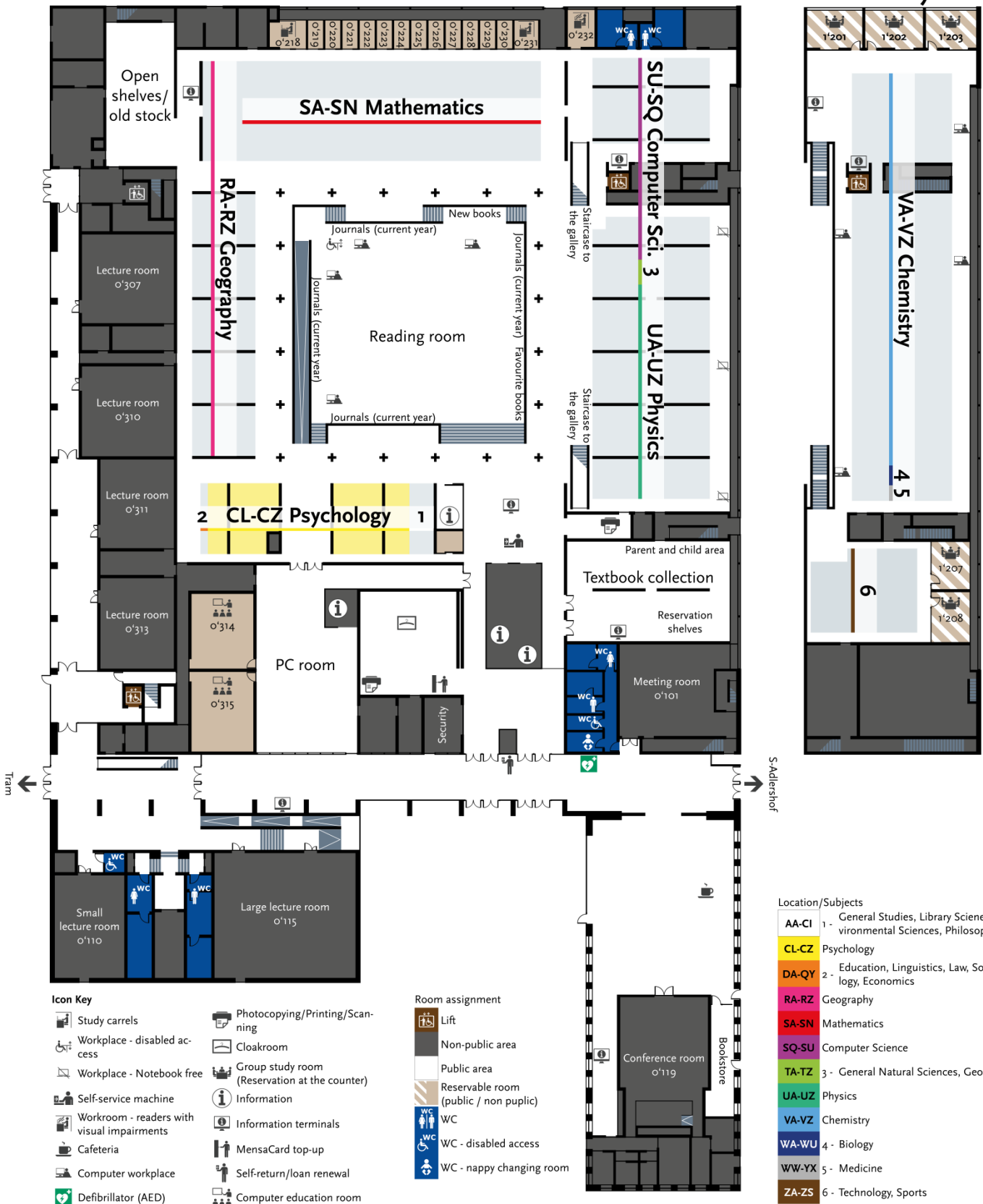

Icon Key

- Study carrels
- Workplace - disabled access
- Workplace - Notebook free
- Self-service machine
- Workroom - readers with visual impairments
- Cafeteria
- Computer workplace
- Defibrillator (AED)
- Photocopying/Printing/Scanning
- Cloakroom
- Group study room (Reservation at the counter)
- Information
- Information terminals
- MensaCard top-up
- Self-return/loan renewal
- Computer education room

Room assignment

- Lift
- Non-public area
- Public area
- Reservable room (public / non public)
- WC
- WC - disabled access
- WC - nappy changing room

Location/Subjects

- AA-CI** 1 - General Studies, Library Science, Environmental Sciences, Philosophy
- CL-CZ** Psychology
- DA-QY** 2 - Education, Linguistics, Law, Sociology, Economics
- RA-RZ** Geography
- SA-SN** Mathematics
- SQ-SU** Computer Science
- TA-TZ** 3 - General Natural Sciences, Geology
- UA-UZ** Physics
- VA-VZ** Chemistry
- WA-WU** 4 - Biology
- WW-YX** 5 - Medicine
- ZA-ZS** 6 - Technology, Sports